

MEMO

To: Northfield Township Board
From: Howard Fink
Date: 9/8/2016
Re: Scadin Lake and Branch Drain

Dear Township Board,

Per the Drain Code Act MCL 280.197, if it appears that the boundaries of a drainage district should be revised, the drain commissioner can hold a day of review of district boundaries pursuant to subsection (4) and, after notice and review, may revise the boundaries of the drainage district. Recently, the Scadin Lake and Branch Drain has come under such a review. I am not very familiar with this drainage area and will become more acquainted by the meeting on Tuesday. Part of this area falls within Northfield Township. As such, we would be assessed a small annual charge associated with maintenance of this drain. It is a small assessment for the Township, 6.06% of maintenance costs associated with this district. This did go up slightly from 5.66%. Last year, our annual maintenance fee came to \$502.77. Does the board wish to object to the costs? These are discussions that we should have on Tuesday, as once we receive notice, the timeline becomes condensed.

Respectfully Submitted,

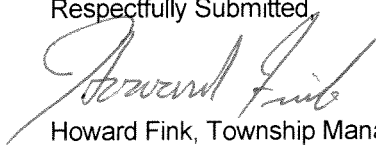

Howard Fink, Township Manager



WASHTENAW COUNTY WATER RESOURCES COMMISSIONER
EVAN N. PRATT

SCADIN LAKE AND BRANCH DRAIN

NOTICE OF DAY OF REVIEW OF DRAINAGE DISTRICT BOUNDARIES AND REVIEW OF APPORTIONMENTS

DATE: September 14, 2016
TIME: 9:00 a.m. – 5:00 p.m.
LOCATION: Washtenaw County Office of the Water Resource's Commissioner
705 N. Zeeb Rd; 2nd floor
Ann Arbor, Michigan 48103
QUESTIONS: (734) 222-6860

The Day of Review is for the purpose of reviewing and revising the boundaries of the SCADIN LAKE AND BRANCH DRAIN Drainage District, and also to review the apportionment of benefit for the Drain for each parcel and municipality within the Drainage District. A map of the proposed Drainage District boundary revisions can be found on the reverse side of this notice and on the Washtenaw County website at: www.ewashtenaw.org/wrcnotices.

The Day of Review is an opportunity to review the Drainage District boundaries and apportionments with the Water Resources Commissioner or a member of his staff. The Water Resources Commissioner, engineers and other staff members will be available to assist individuals throughout the day, and make revisions where necessary. There is no need to schedule an appointment for a specific time on the Day of Review.

Proceedings conducted at this public meeting will be subject to the provisions of the Michigan Open Meetings Act. Information regarding this meeting may be obtained from the Washtenaw County Water Resources Commissioner's Office located at 705 N Zeeb Rd, Ann Arbor, MI 48103.

Persons with disabilities needing accommodations for effective participation in the meeting should contact Human Resources, 734-222-6800, TDD # 734-994-1733, P.O. Box 8645, Ann Arbor, Michigan 48107-8645 at least 24 hours in advance of the meeting to request mobility, visual, hearing or other assistance.

You may appeal the Water Resources Commissioner's decision to revise the district boundary to the Washtenaw County Circuit Court within ten (10) days, and you may also appeal the determination of apportionments to the Washtenaw County Probate Court within ten (10) days.

SCADIN LAKE & BRANCH #8277		Parcels	\$/parcel	Totals	Percentage
		845	\$0.67	\$564.17	50.00%
Tot. P.O. \$ = \$1,128.34					(30%-50%)
		Adj. Acres	\$/Acre		
ESTIMATED		2330.12	\$0.24	\$564.17	50.00%
ASSMT AMT	\$8,299.20		0.242121	\$1,128.34	100.00%
		Average	\$1.32	Max	\$9.19
Total Assessed = \$8,299.20		Median	\$1.07	Min	\$0.71

		Current total dollars assessed		\$8,299.20
Washtenaw County Road Commission		2.6728%		\$221.82
B <i>Northfield</i>	Township at-large	6.06%		\$502.77
C	Township at-large	23.94%		\$1,986.99
	Total Others 32.67%			
Property Owners Total 67.33%			\$5,587.62	
B	Property Owners	13.5958%		\$1,128.34
C	Property Owners	53.7314%		\$4,459.28
Total Apportionment For Drain		100.00%		\$8,299.20

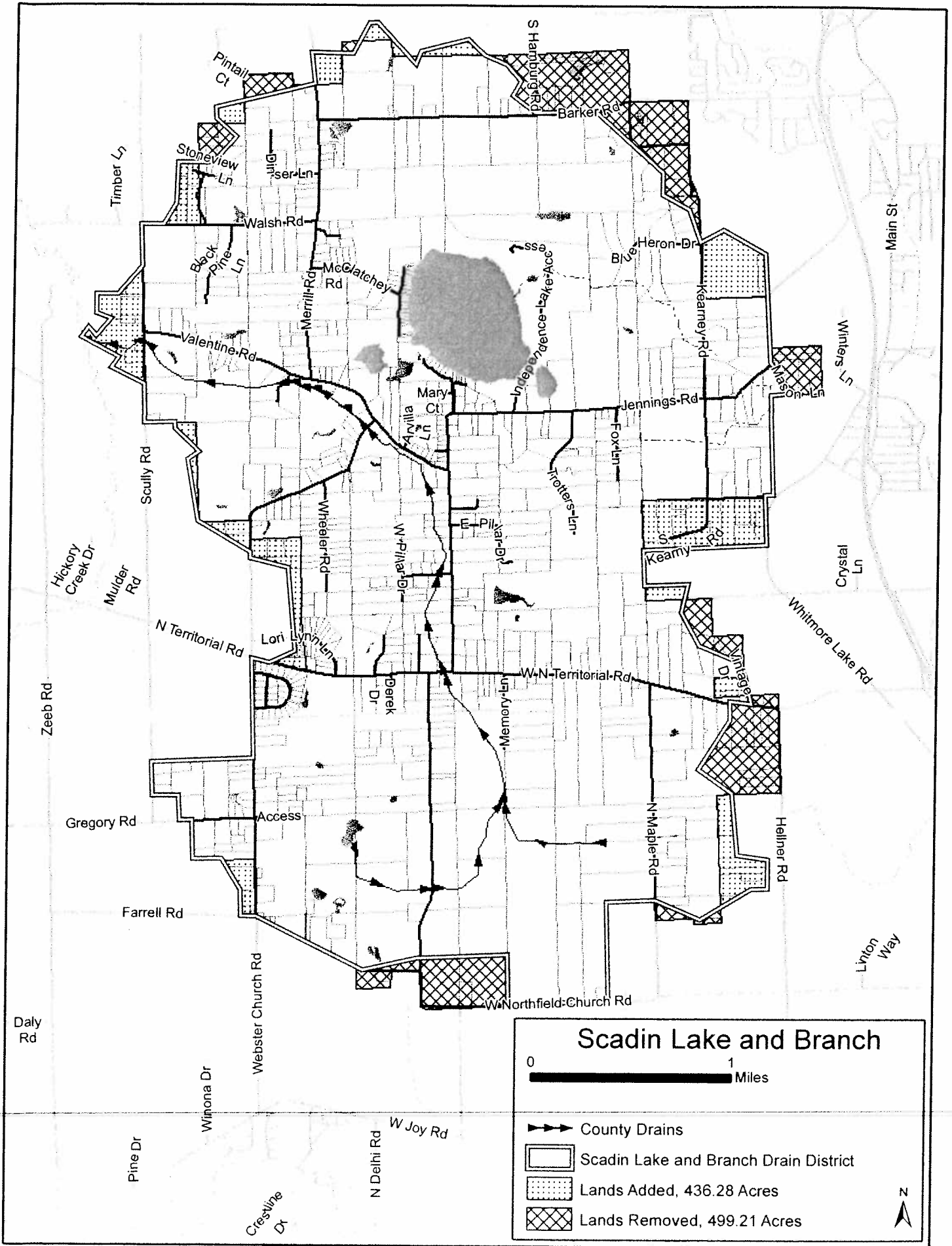

2016 DAY OF REVIEW OF DISTRICT BOUNDARIES
SEPTEMBER 14, 2016

Scadin Lake and Branch Lands Added and Removed

Lands Added

Northfield Township

- 59.74 acres in Section 7 east of Kearney Road and west of Jennings Road
- 108.85 acres in Section 18 south of Kearney Road, north of W. Five Mile Road, and west of Whitmore Lake Road
- 9.92 acres in Section 19 west of Vintage Drive
- 46.57 acres in Section 30 west of Hellner Drive

Webster Township

- 6.96 acres in Section 1 north of Barker and west of Hamburg Road
- 23.75 acres in Section 2 north of Barker and east of Merrill Road
- 32.21 acres in Section 3 west of Stoneview Lane
- 61.89 acres in Section 10 west of Scully Road
- 30.31 acres in Section 14 East of Webster Church Road
- 25.23 acres in Section 15 west of Webster Church Road
- 11.51 acres in Section 23 north of North Territorial Road and north and south of Lori Lynn Lane
- 17.92 acres in Section 27 west of Webster Church Road and north of Farrell Road

Lands Removed

Northfield Township

- 72.31 acres in Section 6 south of Barker Road
- 39.15 acres in Section 7 west of US-23
- 125.37 acres in Section 19 south of W. Five Mile Road and north and south of W. North Territorial Road
- 9.34 acres in Section 30 east of Maple Road

Webster Township

- 119.3 acres in Section 1 north of Barker Road, east of Kearney Road and south of W. Eight Mile Road
- 21.87 acres in Section 2 north of Barker Road and east and west of Merrill Road
- 17.89 acres in Section 3 east of Scully Road
- 39.88 acres in Section 25 north of W. Northfield Church Road
- 48.31 acres in Section 26 north of W. Northfield Church, east and west of Jennings Road and north and south of Farrell Road